

UNION ELECTRICS

Modular Contactor



Type And Signification

UN	MCW	□	□	□
Company Code	Modular Contactor	2-Pole 4-Pole	Rated Current 16A 20A : 63A 100A	Control Voltage AC 24V AC 110V AC 230V

Application Range

The breadth of the ICT contactor range satisfies most application cases. UNMCW contactors can be combined with auxiliary control, protection and indication functions. UNMCW contactors are available in two versions:

- Contactors without manually-operated.
- Contactors with manually-operated.

UNMCW contactors can be used to remote control applications in alternative networks:

- lighting, heating, ventilation, roller blinds, sanitary hot water.
- Mechanical ventilation systems, etc.
- load-shedding of non-priority circuits.



Dual control BACTc

Used to control a contactor in impulse-type mode or to combine latched or impulse-type control orders



230VAC
24VAC



Indication BACTs

This auxiliary allows indication or control of the "open" or "closed" position of the contactor power contacts

Operation (Manual Control Contactor)

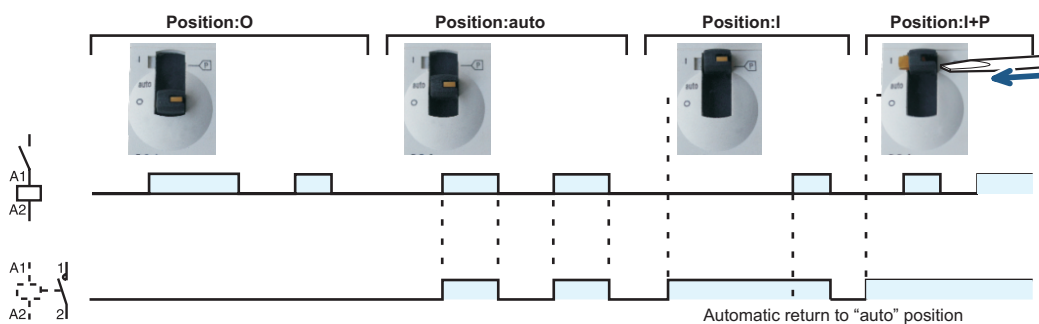

Catalogue numbers



Type	Rating(In) AC-7a	Rating(In) AC-7b	Control voltage (VAC)(50Hz)	Contact	Holding	Inrush	Max. power	Width in 9 mm modules	
1P	16A	6A	24	1NO 1NC	3.8VA	15VA	1.3W	2	
	20A	7A	110		2.7VA	9.2VA	1.2W		
	25A	8.5A	230		2.7VA	9.2VA	1.2W		
2P	16A	6A	24	2NO	3.8VA	15VA	1.3W	2	
	20A	8.5A	110		2.7VA	9.2VA	1.2W		
	25A	8.5A	230		2.7VA	9.2VA	1.2W		
	40A	32A	15A	24	1NO+1NC	4.6VA	34VA	1.6W	4
		40A	15A	110		4.6VA	34VA	1.6W	
		63A	20A	230	2NC	4.6VA	34VA	1.6W	4
				24		6.5VA	53VA	2.1W	
100A	-	110		6.5VA	53VA	2.1W	6		
		230		6.5VA	53VA	2.1W			
		24		6.5VA	53VA	2.1W			
3P	16A	6A	24	3NO	4.6VA	34VA	1.6W	4	
	20A	8.5A	110		4.6VA	34VA	1.6W		
	25A	8.5A	230		4.6VA	34VA	1.6W		
	40A	15A	24	3NC	6.5VA	53VA	2.1W	6	
			110		6.5VA	53VA	2.1W		
			230		6.5VA	53VA	2.1W		
4P	16A	6A	24	4NO	4.6VA	34VA	1.6W	4	
	20A	8.5A	110		4.6VA	34VA	1.6W		
	25A	8.5A	230		4.6VA	34VA	1.6W		
	32A	15A	24	4NC	6.5VA	53VA	2.1W	6	
			110		6.5VA	53VA	2.1W		
	40A	15A	230	2NO+2NC	6.5VA	53VA	2.1W	6	
			24		6.5VA	53VA	2.1W		
	63A	20A	230	3NO+1NC	6.5VA	53VA	2.1W	6	
			24		6.5VA	53VA	2.1W		
110			6.5VA		53VA	2.1W			
100A	-	230		6.5VA	53VA	2.1W	12		
		24	6.5VA	53VA	2.1W				

UNION ELECTRICS

Modular Contactor

Catalogue Numbers



Type	Rating(In) AC-7a	Rating(In) AC-7b	Control voltage (VAC)(50Hz)	Contact	Holding	Inrush	Max. power	Width in 9 mm modules
2P	16A	6A	24	2NO 1NO+1NC 2NC	2.7VA	9.2VA	1.2W	2
	20A	8.5A	110					
	25A	8.5A	230		4.6VA	34VA	1.6W	4
	32A	15A	24					
	40A	15A	110					
63A	20A	230						
4P	16A	6A	24	4NO 4NC 2NO+2NC 3NO+1NC	4.6VA	34VA	1.6W	4
	20A	8.5A	110					
	25A	8.5A	230					
	32A	15A	24		6.5VA	53VA	2.1W	6
	40A	15A	110					
	63A	20A	230					

Dimensions(mm)

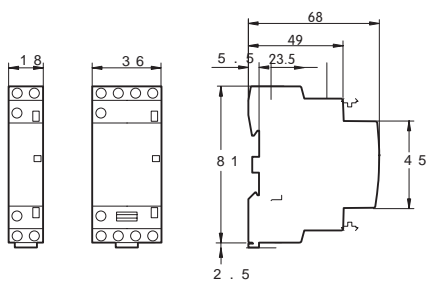

UNMCW-16/25A

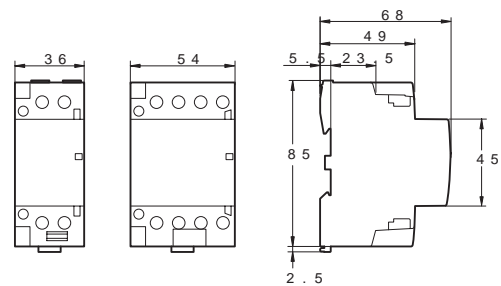

UNMCW-40/63A

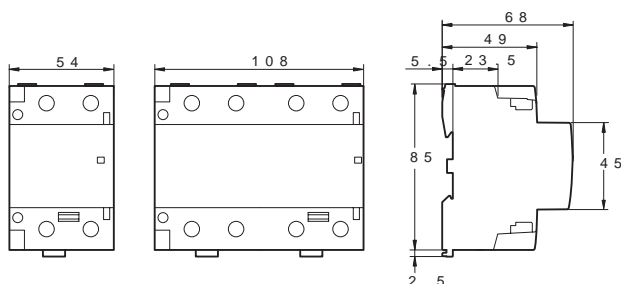

UNMCW-100A